

Gas Station Container Double wall with optional Office-Room and Generator-Set Room

The mobile gas-station container is a cubic, double wall construction. It is integrated in an ISO-Container-frame and combines all advantages of the system in itself, which refers particularly to:

- Transport - approval for ship, rail and road
- Storage - 8x stackable,
- Security - high, static firmness; double-wall construction with vacuum leakage indicator,
- Storage capacity - optimized space usage due to cubic building form

In the tank body of the mobile gas-station container more function niches are built, which are for placement of technological building-blocks. Available with optional:

- Gasoline pump,
- Office room for operating personnel,
- Transfer pump for refueling from tank car without self-pumping system,
- Diesel Generator-Set for power supply to the gas-station container for autarkic operation, without firmly installed connection to power supply system.

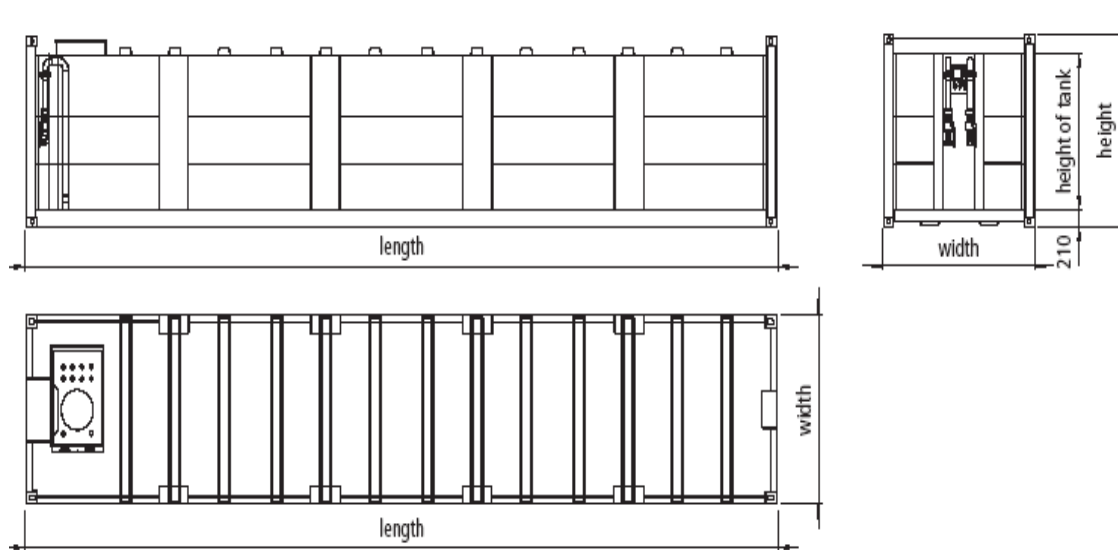

Dead weight	Height of tank	Height	Width	Length	Volume	Type of tank
kg (approx.)	mm	mm	mm	mm	liter	Item No
2.400	2.000	2.438	2.438	2.991	10.000	10ft.
5.600	2.000	2.438	2.438	6.058	24.000	20ft.
10.000	2.000	2.438	2.438	12.192	50.000	40ft.

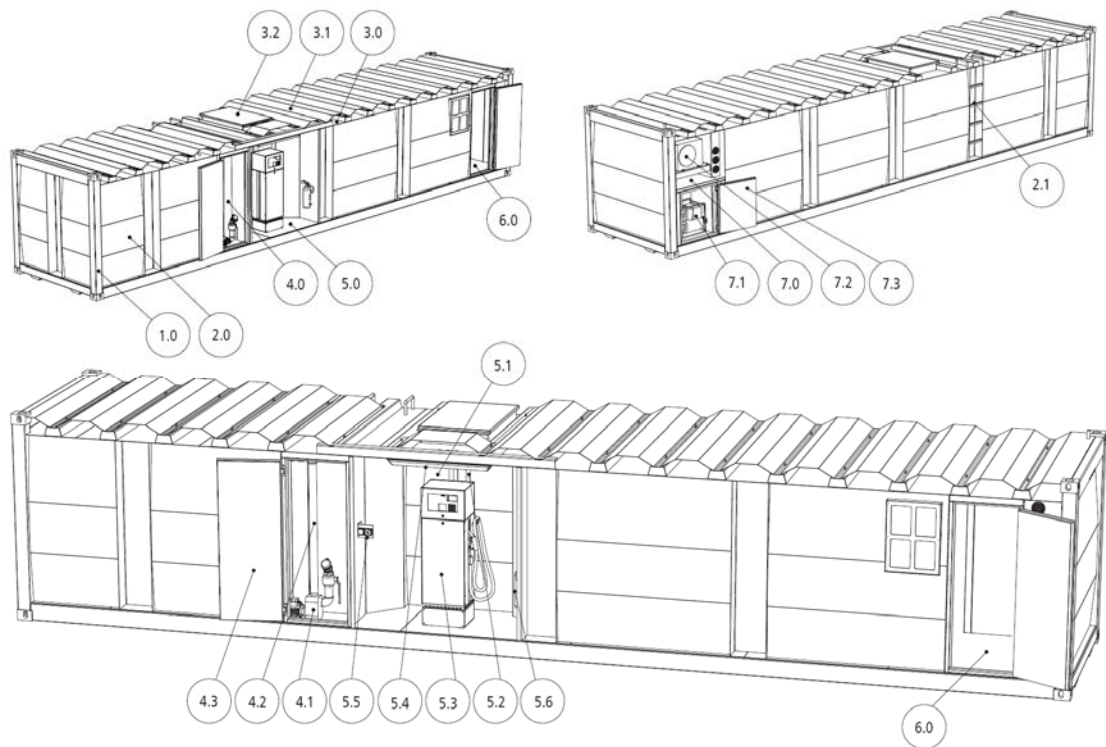

Description of System

1.0 Load-carrying-system construction, consisting of

stable frame structure with 8 pieces ISO-corners

2.0 Robust cubic double wall body of steel, material: S 235 JRG 2

2.1 ladder for climbing (steps of climbing mounted in one of the external niches).

3.0 Tank roof is a self-supporting single wall construction.

3.1 - sun blind and lightning rod for lightning protection

3.2 - hatch compartment, mounted on the tank roof, consisting of:

- A sealing hood with a gas pressure spring, a handle strip and a padlock
- A man hole DN 500
- Access interfaces (bush 2")
- Vent connections DN 50, a vent hood 2" IG
- A mechanical level indicator (fuel dip stick)
- Emptying of residues

4.0 Filling niche, long side:

Width 800 mm

Depth 500 mm

Height 2.000 mm

4.1 - transfer pump 600 liter/min

4.2 - filling conduit with paperwork

4.3 - sealing door, lighting with switch

4.4 - Leak warning device

4.5 - Electrical connection

5.0 Function niche, long side, dispensing unit niche

Width: 2.000 mm

Depth: 1.000 mm

Height: 2.000 mm

6.0 Office-room equipment:

- Internal unit of air conditioner
- Power distribution
- Sealing door and window
- Lighting with switch.

7.0 Gen-Set room equipment:

7.1 - diesel generator set, ca. 5kW

7.2 - external unit of air conditioner

7.3 - sealing door, lighting with switch

Corrosion Protection:

- Inside: rough, oiled
- Outside: 2-K coating

- RAL 3003 (ruby)

- RAL 5007 (brilliant blue)

- RAL 7032 (pebble grey)

- RAL 8001 (ochre brown)

Optional Equipment:

- Coating in all RAL colors
- Material stainless steel

Application areas	Media	Volumes	Dispensing units
Distribution of mineral oil	Diesel	20.000 liter = 20' ISO-Container 40.000 liter = 40' ISO-Container	Delivery rate 45-120 liter/min
Military	Gasoline		- Non-calibrated For own needs
Mining area	Kerosene		
Aid organizations	Biodiesel		- Calibrated versions For reselling. Counting device with liter and price or fully electronic accounting.
Logistics and freight forwarding	Bio-ethanol		

Optional equipment:

Typical Fuel Dispenser Specifications

- Overfilling protection
- Level sensor
- Equipment function niche, front side:
 - Filling system for tank cars
 - Withdraw system
- Limiting level transmitter
- Safety features: buzzer, flashlight
- Chemical-resistant special coating
- Equipment for easily inflammable media
- Thermal insulation
- Strainer, pumps, system control
- Fire extinguisher

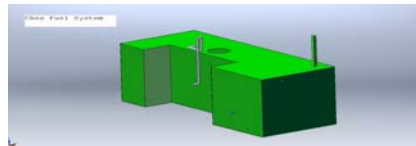

- Applicable media: diesel, biodiesel, gasoline, kerosene, bio-ethanol, AD-blue
- design: calibrated
 - 1x pump compact block with degassing device and strainer
 - Delivery rate max. 90 liter/min
 - electrical connection 3 x 230 VAC, 50Hz
 - designed for temperatures from -20 to +50 °C
 - 1x counting device: piston meter
 - 1x dispensing tube: 4 m DN 25, with automatic dispensing valve, dispensing tube holder





Typical 40ft Gas Station Container



א. תעשייה מס' 3 ת.ד. 262 מעלות תרשיחא 21071 | טל. 04-9574671 | פקס. 04-9997395
E-mail: Sales@chenfuel.com | Web: www.chenfuel.com | Web: www.chenfuel.co.il



Standard Diesel Generator 5KVA



Transfer Pump for Self Filling



Fuel Dispenser (Diesel, Gasoline)



Air conditioner



חן מערכות דלק
CHEN FUEL SYSTEM

א. תעשייה מס' 3 ת.ד. 262 מעלות תרשיחא 21071 | טל. 04-9574671 | פקס. 04-9997395
E-mail: Sales@chenfuel.com | Web: www.chenfuel.com | Web: www.chenfuel.co.il